

REDUTORES A ENGRENAGENS HELICOIDAIS - LINHA H1000

FLANGE PARA MOTORES

FORMA 1 A 9

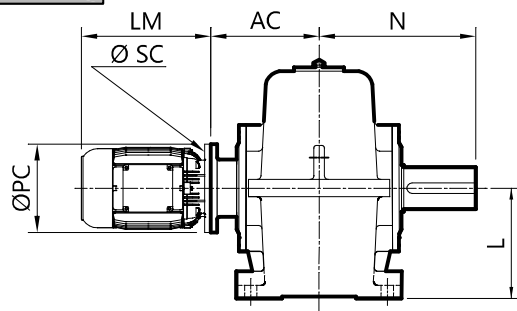

FORMAS 10-11-12-13

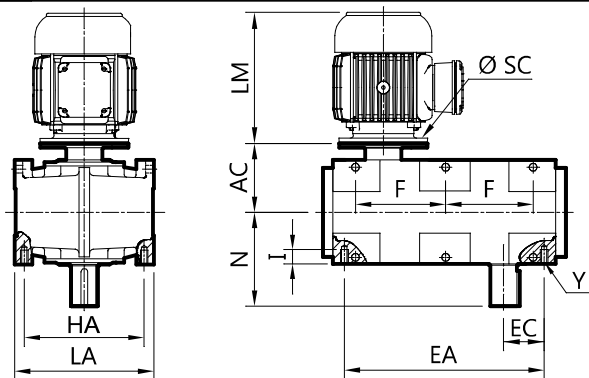

REDUTOR TIPO	MOTOR		N	FLANGE "A" OU "C-DIN"				FLANGE "F"				FORMAS 10-11-12-13					
	CARÇAÇA	LM		TIPO	AC	PC	SC	TIPO	AC	PC	SC	EA	EC	HA	I	LA	Y
H20	80	285	162	C120-20	137.5	120	7	F165-20	212.5	200	12	—	—	—	—	—	—
	90	310		C140-20	147.5	140	9	F165-20	212.5	200	12						
	100/112	363		C160-20	140.5	160	9	F215-20	238	250	15						
	132*	435		—	—	—	—	F265-20	258.5	300	15						
H21	90	310	198	C140-21	162.5	140	9	F165-21	240	200	12	—	—	—	—	—	—
	100/112	363		C160-21	161.5	160	9	F215-21	262.5	250	15						
	132*	435		—	—	—	—	F265-21	274.5	300	15						
H22	90	310	215	C140-22	165.5	140	9	F165-22	253.5	200	12	—	—	—	—	—	—
	100/112	363		C160-22	168.5	160	9	F215-22	275	250	15						
	132*	435		C200-22	204.5	200	11	F265-22	285.5	300	15						
H23	100/112	363	235	C160-23	177.5	160	9	F215-23	271	250	15	—	—	—	—	—	—
	132	435		C200-23	197.5	200	11	F265-23	293	300	15						
	160*	532		—	—	—	—	F300-23	346.5	350	19						
	180*	592		—	—	—	—	F300-23	346.5	350	19						
H24	100/112	363	268	C160-24	181	160	9	F215-24	295	250	15	—	—	—	—	—	—
	132	435		C200-24	198	200	11	F265-24	319	300	15						
	160	532		—	—	—	—	F300-24	370	350	19						
	180*	592		—	—	—	—	F300-24	370	350	19						
H25	100/112	363	305	A215-25	206.5	250	15	F215-25	322.5	250	15	520	151	359	32	400	M16
	132	435		C200-25	206.5	200	11	F265-25	344.5	300	15						
	160	532		—	—	—	—	F300-25	383.5	350	19						
	180	592		—	—	—	—	F300-25	383.5	350	19						
H26	132	435	332	C200-26	213.5	200	11	F265-26	369.5	300	15	560	155	350	32	430	M16
	160	532		A300-26	241.5	350	19	F300-26	408.5	350	19						
	180	592		A300-26	241.5	350	19	F300-26	408.5	350	19						
	200*	657		A350-26	250.5	400	19	F350-26	411.5	400	19						
H27	132	435	372	C200-27	257.5	200	11	F265-27	407.5	300	15	622	186	410	38	468	M22
	160	532		A300-27	302.5	350	19	F300-27	438	350	19						
	180	592		A300-27	302.5	350	19	F300-27	438	350	19						
	200*	657		A350-27	292.5	400	19	F350-27	438	400	19						
	225*	746		A400-27	257.5	450	19	F400-27	437.5	450	19						
	—	—		—	—	—	—	—	—	—	—						
H28	132	435	421	A265-28	306	300	—	—	—	—	705	215.5	446	38	500	M22	
	160	532		A300-28	306	350	19	F300-28	487	350							19
	180	592		A300-28	306	350	19	F300-28	487	350							19
	200*	657		A350-28	293	400	19	F350-28	485	400							19
	225*	746		A400-28	318	450	19	F400-28	490	450							19
H29	160	532	465	A300-29	318.5	350	19	F300-29	520	350	19	795	245.5	502	52	586	M22
	180	592		A300-29	318.5	350	19	F300-29	520	350	19						
	200*	657		A350-29	313.5	400	19	F350-29	521.5	400	19						
	225*	746		A400-29	313.5	450	19	F400-29	530.5	450	19						
	250*	825		A500-29	313.5	550	19	F500-29	530.5	550	19						

FORMAS CONSTRUTIVAS

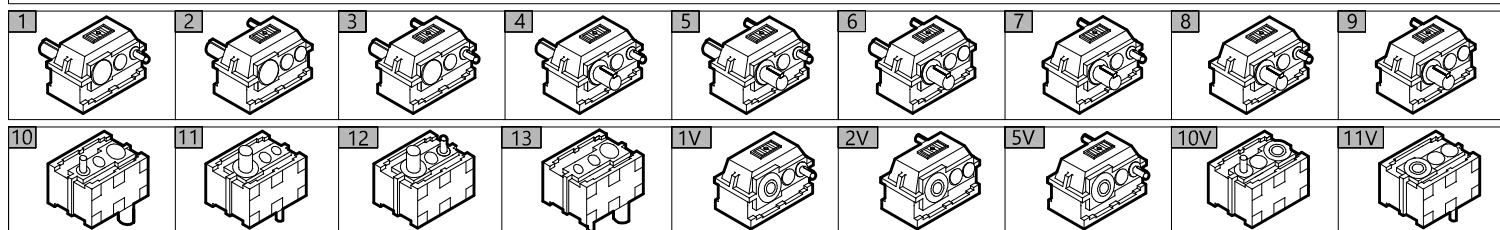

*SOMENTE NAS FORMAS CONSTRUTIVAS 10 E 12
OBS: INFORMAÇÕES SUJEITAS A ALTERAÇÕES SEM AVISO PRÉVIO